

EXTRUSION

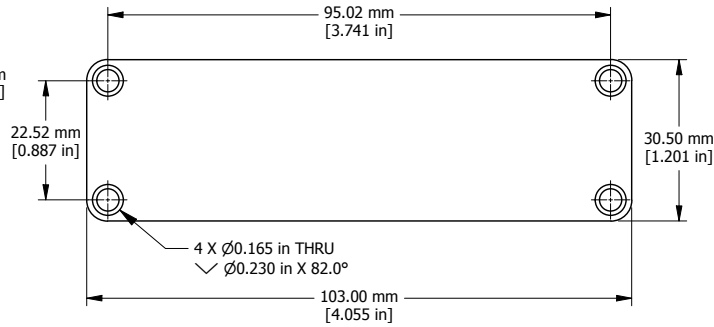

END PLATE

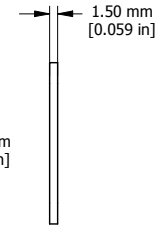

OPTIONAL FLANGE END PANELS  
1455LF

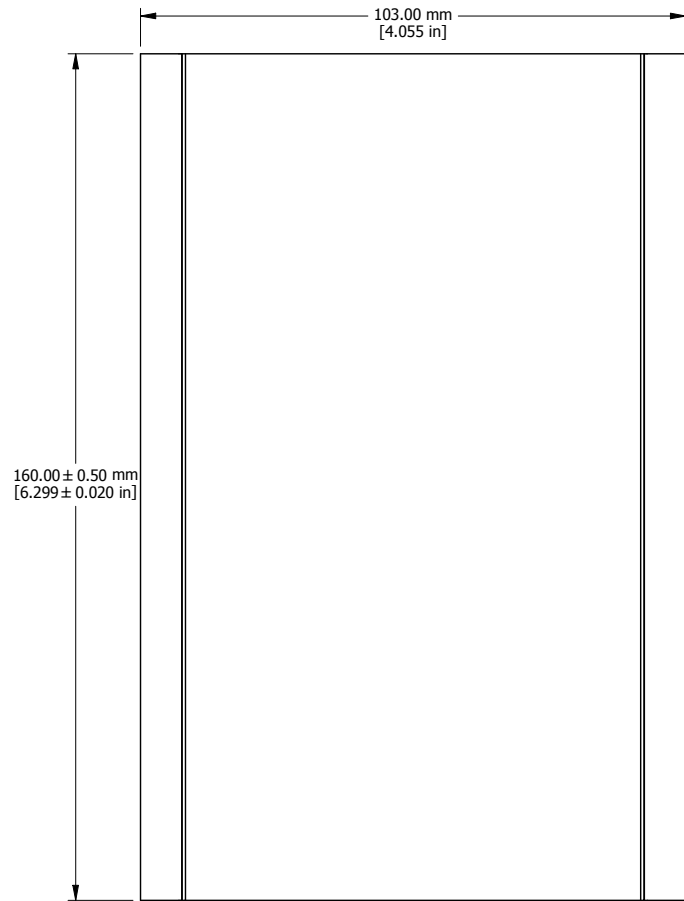

EXTRUSION DESIGNED FOR 100MM WIDE PC BOARD

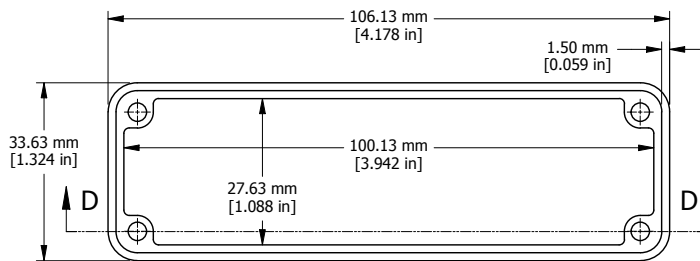

OPEN BEZEL

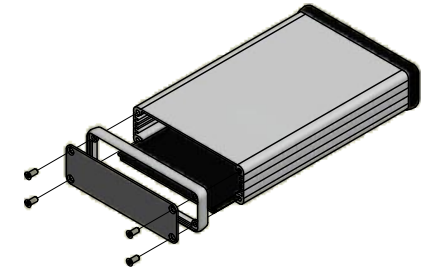
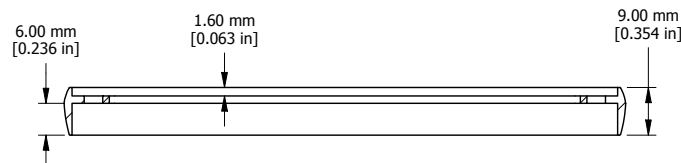

EXPLODED ASSEMBLY VIEW

Enclosures can be Factory Modified ( Milling, Drilling, Printing etc. )  
Solid models of this enclosure available in STEP or IGES.  
Contact Factory [mjm@hammondmfg.com](mailto:mjm@hammondmfg.com)

| NOTE   |  |
|--|--|
| Purchased assembly includes box, plastic bezels, end panels, #6 Taptight screws and self adhesive rubber feet. |  |
| Box made from Extruded Aluminum 6063.  |  |
| Bezels made with polycarbonate.  |  |

| 1455L1601                    |             |
|------------------------------|-------------|
| PART NUMBERS                 |             |
| Clear Anodized               | 1455L1601   |
| Black Anodized               | 1455L1601BK |
| Blue Anodized                | 1455K1601BU |
| Red Anodized                 | 1455K1601RD |
| ACCESSORIES                  |             |
| See website for accessories. |             |

